ENTRY METHOD: FIRST RECEIVED

ENTRIES WILL OPEN ON **February 2, 2022 at 8:00am MST** at the Trial Secretary's address listed in this premium ONLY. All entries received before this date will be returned. Overnight or certified mail must be sent with the "No Signature Required" waiver signed.

PRE-ENTRIES CLOSE ON **March 16, 2022 at 11:59pm MST** after which time entries cannot be accepted, cancelled, altered, or substituted except as provided for in Chapter 11, Section 6 of the Rules Applying to Dog Shows. Envelopes/transactions containing entries for more than the ten (10) dog maximum and/or entries received prior to the opening date shall be treated as an invalid entry and shall be returned to the sender.

IF THE TRIAL HAS NOT FILLED, Day-Of-Trial entries will be accepted on the day of trial starting 30 minutes before start time (8am), up to a maximum of 50 runs.

FAST CAT PREMIUM LIST

Scottsbluff County Kennel Club
(Licensed by the American Kennel Club)

April 1, 2022 Event #2022172308

April 1, 2022 Event #2022172309

April 2, 2022 Event #2022172310

April 2, 2022 Event # 2022172311

April 3, 2022 Event #2022172312

April 3, 2022 Event #2022172313

Scottsbluff County Fairgrounds

13025 County Road, Mitchell, NE 69357

ENTRY LIMITS

2 Trials Per Day, Run Concurrently
100 runs per trial

To be held Outdoors on grass and fully fenced

ENTRY FEES

Early Entry: \$25/run

Late and Day Of Entries (Subject to Availability): \$30/run

TRIAL HOURS:

Rolling Roll Call will begin at 8:00am
Must be checked in to run by 3:00pm

FENCING:

The course will be fenced with 4' rope net fencing.

Additional Trial Information:

www.DogSportsAmerica.com under "Events"



**AMERICAN
KENNEL CLUB**

CERTIFICATION

Permission is granted by the American Kennel Club for the holding of this event under American Kennel Club rules and regulations.

Gina DiNardo, Secretary

OFFICERS OF THE AMERICAN ROTTWEILER CLUB

PresidentSUZANNE LILJA-KINGMA
 Vice PresidentDESIREE THOMAS
 Treasurer.....JEFFREY BOTT
 Secretary.....RENE KELLER
 2337 NW 158th St EDMOND, OK 73013

FIELD CHAIRMAN / TRIAL CHAIRPERSON

LINDA VEAL
 718 Canal St
 Scottsbluff, NE 82601
 lveal@actcom.net
 308-635-2772

TRIAL SECRETARY

JOHN FISHER
 3905 Fairview Drive
 Carson City, NV 89701
 John@DogSportsAmerica.com
 650-444-7800

Mail Entries to: 13120 RARITAN ST WESTMINSTER, CO 80234

FIELD COMMITTEE

SUZANNE KINGMA, JEFFREY BOTT, LINDA VEAL, RENE KELLER, BILL ROSENAU
 (In response to unforeseen circumstances, committee members may be substituted as necessary)

LURE OPERATOR(S)

John Fisher

The club reserves the right to substitute lure operators.

VETERINARIAN ON CALL

PACIFIC ANIMAL HOSPITAL

(636) 257-2100

450 West Flier Drive, Pacific, MO 63069

Friday - 7:00 am to 5:00 pm Saturday - 7:00 am to 12:00 pm Sunday - CLOSED

VSS EMERGENCY CENTER

(AFTER HOURS)

(636) 392-2200

1021 Howard George Dr. Manchester, MO 63121

Open 24hrs

DIRECTIONS TO TOMORROW'S VETERINARY CARE: Directions from the site (approx. 5 miles):
 Leaving Purina, turn right onto Hwy. 100 W. Turn left onto W. Osage St. Turn right onto Cedar Dr. Take first right onto Flier Drive.

EMERGENCY SERVICES

Fire/ Ambulance/Police- Franklin County
911

AKC REGISTRATION

All dogs must be individually registered with the AKC. This includes all AKC registered purebreds, Foundation Stock Service (FSS), Purebred Alternative Listing (PAL), and AKC Canine Partners. Spayed or neutered dogs, or dogs with breed disqualifications may be entered. Not AKC registered? NO PROBLEM! You will be able to register your Canine Partner with AKC at the event, and your dog can participate in the tests that very same day.

AWARDS

A light blue ribbon will be awarded to each dog that receives a qualifying run for the FastCAT.

New Title Rosettes for BCAT/DCAT/FCAT will be awarded.

ENTRIES

BY MAIL: Complete an official AKC entry form for each dog. An entry form is at the end of the premium for your convenience. **ONE ENTRY FORM PER DOG.** A dog may only enter once per trial. Mail completed forms with fees payable to Dog Sports America and send to 13120 Raritan Street, Westminster, CO 80234. Incomplete entries will be deemed invalid.

ONLINE: Online entries will only be accepted from trial opening until the event is full. All entries for the waitlist must be mailed. When trial reaches capacity, online entry will turn off by individual trial.

DAY OF TEST ENTRIES: Day of Test Entries for each dog: \$30, payable in cash at the Trial Secretary table, if space is available.

WITHDRAWING ENTRIES: No entry fees may be refunded if the trial cannot open or be completed by reason of any cause beyond the control of the host club or organizer. No entry fee will be refunded if a dog is absent, disqualified, excused, or banned from competition by the action of the trial committee. Any entries pulled in writing (email/mail) prior to entry closing will be refunded minus any transaction fees. Any entries pulled after closing will be refunded the entry fee less \$10 per day plus transaction fees if someone is on the waitlist to take your spot.

FUN RUNS (time permitting, after the official event each day): \$10 per run. Sign up at the trial secretary table on the day of the event. Fun Runs will be run on a first come, first served basis subject to time availability.

EVENT DETAILS

ROLLING ROLL CALL WILL START AT 8:00AM. You may check in for your run(s) between 8:00AM and 3:00PM, and run as you are ready, as opposed to set run time blocks to accommodate ring conflicts. Please do not wait until the last moment to run. We cannot guarantee there will be time to run if you show up at the end of the day. Runs must be separated by 30 minutes. You must check in for your run(s) at or before 3pm.

CANINE PARTNER REGISTRATION

If your Canine Partner is not yet registered with AKC, simply fill out the Canine Partners Enrollment Application located at the end of this premium list and turn it in along with your entry form and fees (Payment is made directly to AKC. Fill out the credit charge authorization on the Canine Partners form or include a separate check for \$19 payable to AKC).

INSPECTION

Each dog will be inspected by the inspection committee for lameness, fitness to compete, and females in season. All dogs to be inspected must be presented WITHOUT TAPE, BANDAGES, or WRAPPING/COVERINGS of any kind (Coats, blankets, etc.). If, in the opinion of the inspection committee, any entry is found to be lame, unfit to compete or in season, they shall not be allowed to test, and the applicable entry fees shall be refunded.

ROLL CALL AND PRE-TEST BRIEFING

All entrants will check in in a designated location in order for the Field Committee to confirm those entered in the test are present. A tech inspection of the dog will be completed. At this time, test procedures will be explained and any questions answered.

RUNNING YOUR DOG

It is recommended that dogs be handled with a "slip-lead" that gives instantaneous freedom to the dog when the "Tallyho" (release) signal is called by the Huntmaster. The Host Club will have slip leads for you to borrow. Please ask.

Dogs may wear any collar except a choker collar, a collar with prongs or an electronic training collar. The collar should be snug to minimize the chances of getting hung up on something during the run. Owners should be aware that tags hanging from the collar could be required to be removed to help prevent them from being entangled on something during the run. Owners may use clips or rubber bands to hold the dog's hair. The owner assumes responsibility for the safety of the dog regarding the dog's collar and paraphernalia on the dog.

ALL DOGS MUST WAIT A MINIMUM OF 30 MINUTES BETWEEN RUNS. NO BACK-TO-BACK RUNS

FASTCAT SUMMARY DESCRIPTION

The FastCAT Test is a timed 100-yard dash for dogs. It is meant to be a fun and healthy activity of interest to any dog owner. The following is a summary of how the event is structured.

How Does FastCAT Work?

1. FastCAT is a timed straight race of 100 yards.
2. Dogs run singularly.
3. The dog's time to complete the 100-yard dash is converted into MPHs.
4. A handicap system is applied to a dog's MPH to determine the number of points earned. The handicap system is based on the height of the dog at its withers:

- 18" or greater = handicap is 1.0
- 12" up to less than 18" = handicap is 1.5 • Below 12" = handicap is 2.0

5. Points = MPH multiplied by the dog's handicap

6. Fast CAT titles suffix titles are earned at designated milestones:

- BCAT = 150 points
- DCAT = 500 points
- FCAT = 1,000 points
- FCAT# = every additional 500 points

7. Top 20 by Breed by Year: The AKC Fast CAT website will feature the Top 20 Fastest Dogs by Breed by Year national standings. The standings will be updated as event results are processed.

ELIGIBILITY TO PARTICIPATE

8. Open to all dogs at least 12 months of age that are individually registered/listed with the AKC. This includes dogs recorded in the FSS program, dogs with PAL numbers or dogs enrolled in the AKC Canine Partners program. Females in season may not enter. A dog may enter only once per event. (An event number defines an event.)

9. An inspection committee shall inspect each entry for lameness, fitness to compete and females in season. If necessary, the inspection committee is responsible for measuring dogs to determine their height at the withers.

The Course/Equipment

10. Safety: Safety is of utmost importance. It is the responsibility of the event committee to insure the safety of the course, the equipment and the conduct of those involved with the event. It is recommended that the event committee run a test dog prior to the start of the event to ensure that the equipment functions properly and all personnel understand their jobs. Prior to moving the lure to position it for the start, the lure operator shall announce, "hold your dogs" in order to caution owners.

11. The Start: Dogs may start up to 10 feet behind the starting line.

12. The Finish: The club must provide enough room for a safe run-out area. It is suggested this be a minimum of 30 yards, however this is up to the decision of the club given the specifics of the setting. The club should consider fencing the end of the course in order to help collect the dogs. It is recommended that an owner or someone familiar with the dog stand at the finish to catch the dog once the course has been completed.

13. Timing Devices: The time to complete the 100-yard dash is recorded to the nearest 1/100th of a second (e.g. 9.11). The club will use break- the-beam equipment to obtain the time. If the timers fail, stopwatches will be used, there shall be two timers positioned at the finish line. An individual at the start line shall signal with an arm drop the moment the nose of the dog crosses the start line. The timers shall start their stopwatches at the bottom of the arm drop. The timers shall stop their watches when the nose of the dog crosses the finish line. The times from the two stopwatches shall be averaged to determine the recorded time.

14. Lure Equipment: The event will be run with a reversible, variable speed, continuous loop system. The lure operator and the lure equipment shall be safely positioned in a manner that does not interfere with the retrieval of the dog at the end of the course.

15. Lure: A white plastic bag will be used for the lure.

16. Course/Fencing: The course is essentially flat and the course area is fenced.

HUNTMASTER HAS CONTROL OF THE COURSE

17. The Huntmaster has control of the course. In summary, the Huntmaster is in charge of all dogs and handlers on the field, shall ensure handlers understand safe release and retrieval procedures, shall ensure the lure is properly positioned, shall ensure the lure operator, timers and starting line signal person are ready, shall signal the lure operator to start the lure and shall give the verbal signal “tallyho” to release the dog.

NOTICE TO ALL EXHIBITORS

Please ensure the comfort of you and your dogs by bringing your own portable shade/shelter and water.

Restrooms are located in the main exhibit hall.

For the safety of the dog and as a courtesy to other entrants, a testing dog should have a reliable recall. A penalty of \$10.00 may be assessed for any dog causing an excessive delay of the event because it cannot be recalled or retrieved from the field. Dogs that delay the event because their owners cannot recall them may be refused entry at future events.

The Huntmaster is responsible for field safety and therefore s/he is in complete charge of all dogs and handlers on the field. In service to this responsibility, s/he has the authority to stop the lure in any potentially dangerous situation and signal the handler to retrieve a testing dog. Listen to the Huntmaster and follow all instructions promptly and swiftly.

Any decisions made by the event’s officiating judge(s) regarding the performance of an entered dog shall be final. Full discretionary power is given to the judge(s) to withhold any and all qualifications for lack of merit. The Judge(s) is responsible for ensuring compliance with the AKC Regulations on the field.

Exhibitors should follow their veterinarian’s recommendation to assure their dogs are free of internal and external parasites, any communicable diseases and have appropriate vaccinations.

Coursing is an athletic activity that can tax a dog’s physical strength. Dogs that are overweight and/or out of condition may be at greater risk for injury and exhaustion. The Inspection Committee has the authority to disallow a dog’s entry into a test, and in such instances, applicable entry fees will be refunded.

NO BACK-TO-BACK RUNS. You must allow your dog 30 minutes rest between runs.

COURSE AREA IS FENCED. We will be using 4’ high rope netting fence.

No entry fees will be refunded if the event cannot be started or completed by reason of riots, civil disturbances, fire, extreme and/or dangerous weather conditions, an Act of God, public emergency, act of a public enemy, strikes or any other cause beyond the control of the Club or its members and representatives.

Persons exhibiting conduct detrimental to AKC/any dogs(s) and/or other person(s) will be asked to leave the trial site.

The event-hosting club, its agents, members, representatives, volunteers, etc., assume no responsibility for any loss, damage or injury sustained by exhibitors, handlers, or to any of their dogs or property and further assumes no responsibility for injury to children or spectators.

All rights to televise, videotape, advertise, photograph, promote or otherwise exploit this event are vested in the club, or in persons to whom assignments of such rights have been made in writing by the club. All persons and animals attending these shows grant the club the right to use their likeness and voice in any matter without further consent.

Entry fees submitted and accepted will be refunded in full if the withdrawal of said entries are requested by the dog's owner or agent prior to the closing deadline for entries. Requests must be made in person to the DSA. No refunds for pre-entry fees unless the entered dog upon inspection is lame, unfit to compete, or in season. Refunds for bitches in season will be refunded less \$5.00 per run, if requests are submitted in writing to the Field Secretary with a veterinarian certificate at least 30 minutes prior to the start of judging for the day the bitch is registered, or presented to a FastCAT inspection committee member for inspection prior to the start of the trial day for which they are registered.

Females in season are NOT allowed on the site except for inspection.

Late, incomplete, unsigned, unpaid or conditional entries, or entries not containing the "Agreement" found on the Official AKC Entry Form will not be accepted.

Substitution of dogs will be accepted at the time of roll call/inspection. Once inspection is complete, no further substitution will be allowable.

A return check fee of \$35.00 will be assessed for any check(s) returned for insufficient funds.

ALL ENTRIES MUST BE LEGIBLE OR THEY WILL NOT BE ACCEPTED!!!

YOU MUST HAVE 1 ENTRY FORM PER DOG, NO EXCEPTIONS!!! ELECTRONIC ENTRIES CAN BE MADE.

IF YOU DO NOT SHOW UP FOR YOUR RUN, DURING THE RUN TIME WINDOW, YOU WILL FORFEIT YOUR RUN!! WE WILL DO OUR BEST TO ACCOMMODATE CONFLICTS. DON'T SHOW UP AT THE END OF THE DAY AND EXPECT TO GET BOTH RUNS IN. NO MAKE UP RUNS!!

DIRECTIONS TO THE TRIAL SITE

DIRECTIONS TO SCOTTS BLUFF COUNTY FAIRGROUNDS

13025 County Road, Mitchell, NE 69357

Take Highway 26 into Mitchell, turn south at the Junction of Hwy 26 & Hwy 29. Cross the railroad tracks & immediately turn west (right).

Take Highway 92/29W to Mitchell junction. Turn north on Hwy 29 & go approximately 6 miles into Mitchell. Turn west just before crossing the railroad tracks.

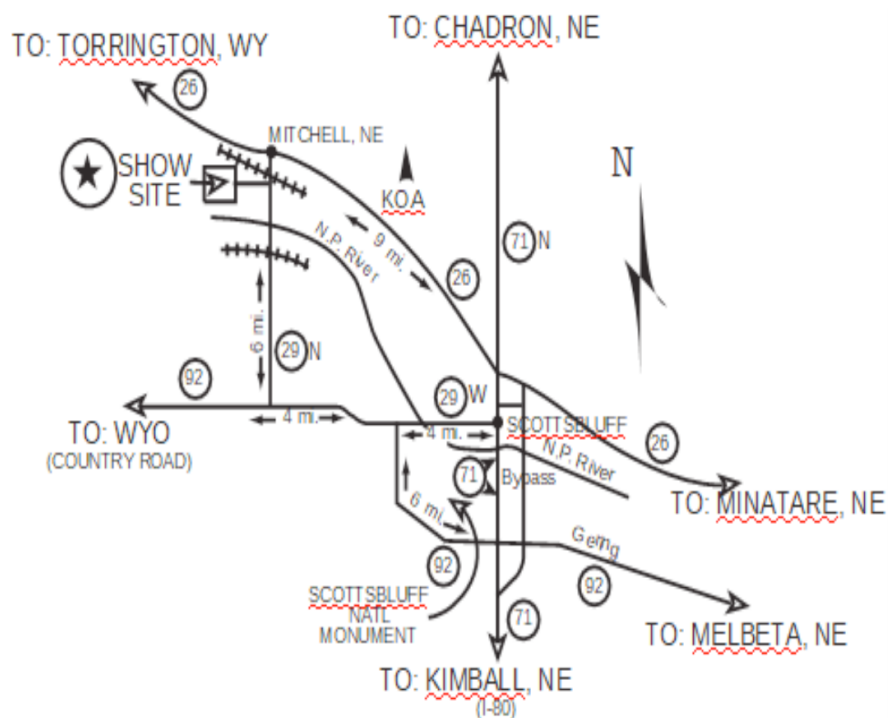

HOTEL INFORMATION

HOTELS & MOTELS THAT WILL ACCEPT DOGS

Monument Inn & Suites.....(866)436-1950
1130 M St, Gering NE 69341

American Inn.....(308) 632-7108
606 E 27th St, Scottsbluff NE

Capri Motel.....(308) 635-2057
2424 Ave I, Scottsbluff NE

Quality Inn (previously Comfort Inn).....(308) 632-7510
1902 21st Ave, Scottsbluff NE 69361

Circle-S Lodge.....(308) 436-2157
410 M St, Gering NE

Cobblestone Inn & Suites Hotel.....(308) 633-7660
960 M St, Gering NE

Travelodge.....(308) 217-4327
707 E Webster, Morrill NE

Days Inn.....1-800-597-3111 or (308) 635-3111
1901 21st Ave, Scottsbluff NE

RV PARKING ON SITE

ROBIDOUX RV PARK.....(308) 436-2046
585 FIVE ROCKS RD, GERING NE 69341

EACH EXHIBITOR WILL BE HELD RESPONSIBLE FOR CLEANING UP AFTER THEIR DOGS ON THE GROUNDS OF THESE MOTELS. DAMAGES TO ROOMS OR GROUNDS WILL BE REPORTED TO THE EVENT COMMITTEE AND TO THE AKC



AKC Canine PartnersSM Listing Application



MX1AB

Use this application to list a mixed-breed dog or dog ineligible for AKC registration/recording. Complete all sections and return form to: AKC Canine Partners, PO Box 900075, Raleigh, NC 27675-9075. Information you omit will delay processing. Listing is not guaranteed. Fees are nonrefundable and subject to change without notice. For more information or to complete online go to www.akc.org or call (919) 233-9767, Monday-Friday, 8:30 am - 5:00 pm.

Please complete all required fields

Dog Name – Official AKC Listed Dog Name. Print one capital letter per box. Skip a box between words. Names are subject to AKC approval.

Extended Dog Name – Add an additional fee of \$10 in the payment section if your dog name extends to the section below, not to exceed 50 spaces.

Dog's Call Name: _____

Please select the color/markings that most closely describes your dog. Select only one color and one marking.

Sex: Male Female

Date of Birth: - -
Month Day Year

(Enter date of birth if known. Otherwise select approximate date.)

- Color:
- Black
 - Blue
 - Brown
 - Yellow
 - Gray
 - Orange
 - Red
 - Tan
 - White
 - Tri-color
- Markings (if applicable):
- Brindle
 - Merle
 - Parti-color
 - Speckled
 - Spotted
 - Solid

Microchip Number: _____

Dog type (optional): Breed one _____ Breed two _____ or All American Dog (see page 2 for instructions)

Owner Information

Owner's First Name

Owner's Last Name

Date Acquired:

Enter date acquired if known. Otherwise select approximate date.

 - -
Month Day Year

Mailing Address

City

State

ZIP code + 4

Telephone Number

Email Address*

Co-Owner information if applicable. Download the Additional Signature Form to record more than two owners at www.akc.org/pdfs/ADSIG1.pdf.

Co-Owner's First Name

Co-Owner's Last Name

Read and Sign Below

I (WE) APPLY TO THE AMERICAN KENNEL CLUB TO HAVE AN AKC CANINE PARTNERS OFFICIAL DECREE FOR THIS DOG ISSUED IN MY (OUR) NAME(S). I (WE) CERTIFY THAT ALL THE INFORMATION APPEARING ON THIS APPLICATION IS TRUE AND CORRECT. I (WE) CERTIFY THAT THIS DOG HAS BEEN SPAYED/NEUTERED OR THAT IT, BEING A PUPPY, WILL BE SPAYED/NEUTERED AT SUCH TIME AS RECOMMENDED BY MY VETERINARIAN AND THAT I (WE) WILL SUBMIT WRITTEN VERIFICATION IF REQUESTED BY THE AMERICAN KENNEL CLUB. I (WE) CERTIFY THAT THIS DOG IS NOT A WOLF OR THE IMMEDIATE PROGENY OF A WOLF/CANINE CROSSBREEDING. I (WE) UNDERSTAND THAT IF THIS DOG IS IDENTIFIED AS A WOLF OR THE IMMEDIATE PROGENY OF A WOLF-DOG CROSSBREEDING, IN THE PAST OR IN THE FUTURE, THE AKC WILL CANCEL THE DOG'S AKC CANINE PARTNERS OFFICIAL DECREE. ADDITIONALLY, I (WE) UNDERSTAND THAT FALSELY CERTIFYING THE ABOVE INFORMATION MAY SUBJECT ME (US) TO DISCIPLINARY ACTION. I (WE) AGREE TO ABIDE BY ALL THE RULES AND REGULATIONS OF THE AMERICAN KENNEL CLUB. I (WE) CERTIFY THAT IF THE OWNER OF THIS DOG IS A MINOR THAT THE APPLICATION WILL BE SUBMITTED WITH THE PARENTAL/GUARDIAN CERTIFICATION FORM. I (WE) AGREE THAT ANY CAUSE OF ACTION, CONTROVERSY OR CLAIM ARISING OUT OF OR RELATED TO THIS LISTING OR AS TO THE CONSTRUCTION, INTERPRETATION AND EFFECT OF THIS AGREEMENT SHALL BE SETTLED BY ARBITRATION PURSUANT TO THE APPLICABLE RULES OF THE AMERICAN ARBITRATION ASSOCIATION. HOWEVER, PRIOR TO ARBITRATION ALL APPLICABLE AMERICAN KENNEL CLUB BYLAWS, RULES, REGULATIONS AND PROCEDURES MUST FIRST BE FOLLOWED AS SET FORTH IN THE AMERICAN KENNEL CLUB CHARTER AND BYLAWS, RULES, REGULATIONS, PUBLISHED POLICIES AND GUIDELINES.

See instructions for listing of dogs owned by minors on the back of this form.

Owner's Signature (Required)

Co-Owner's Signature (Required)

Payment Information

AKC Canine Partners Listing _____ \$

Extended Dog Name – Enter a fee of \$10 only if your dog's name exceeds 36 spaces. _____ \$

Payment Method: VISA AMEX MasterCard Discover Check or money order made payable to: Total Fee \$
The American Kennel Club.

Account Number (do not include dashes)

 -

Expiration Date

Printed Name of Cardholder

*By supplying your email address and/or telephone number, you consent to receive communications from AKC and third parties.

**Eligibility Requirements and Submission Instructions**

Purpose	Use this application to list a spayed/neutered mixed-breed dog or dog ineligible for AKC registration/recording.
Eligibility Requirements For AKC Canine PartnersSM Listing	<p>Eligibility Criteria:</p> <ul style="list-style-type: none"> • The dog must be spayed/neutered, or if it is a puppy it will be spayed/neutered at such time as recommended by your veterinarian. Written verification will be provided to the American Kennel Club upon request. • No wolf-dog hybrid will be permitted an AKC Canine Partners Listing. <p>If requested, the owner must submit proof to verify compliance with these requirements.</p>
Mailing Information	Send the completed application and attachments to: AKC Canine Partners PO Box 900075 Raleigh, NC 27675-9075
Additional Requirements	If there are more than two (2) owners of the dog, contact the AKC for an Additional Signature form. If one of the owners of the dog listed is a minor, contact the AKC for the Parental/Guardian Registration Certification form. Note: This form is available on our website: www.akc.org .
Authorizations	Signatures of persons other than the owner(s) will be accepted only if a properly completed authorization form has been filed with the AKC. Note: This form is available on our website: www.akc.org .
Assistance	Email AKC at info@akc.org or call 919-233-9767 to speak to an AKC Customer Service Representative, Monday – Friday, 8:30 AM – 8:00 PM. Information about the registration process and downloadable forms are available on our website: www.akc.org . For more information about the Lost & Found Option, visit www.akc.org/lostfound . By supplying your email address and/or telephone number, you consent to receive communications from AKC and third parties.
Notice	The American Kennel Club reserves the right to correct or cancel for cause the listing of this dog and its descendants. Any misrepresentation on this application is one example of for cause cancellation and may result in loss of AKC privileges. By supplying your email address and/or telephone number, you consent to receive communications from AKC and third parties. Listing is not guaranteed. Fees are nonrefundable and subject to change without notice. Once submitted, this application becomes the property of the American Kennel Club.
Dog Type	<ol style="list-style-type: none"> 1. Dog type may be left blank. 2. Fill in up to two AKC breeds. 3. If you would like dog type to appear as "An All American Dog," check box and leave the breed one and breed two boxes blank.

AKC Canine Partners Listing Benefits

Enroll your dog today to receive special listing benefits and an AKC number for competition eligibility in Agility, Obedience, AKC Rally,[®] Tracking, AKC Scent Work, and Coursing Ability events.

Enroll your dog today for the one-time fee of \$35 to receive special AKC benefits (worth up to \$100)!

- 30 days of pet insurance from AKC Pet Insurance*
- Lifetime enrollment in AKC Reunite Lost & Found Recovery Service
- One-year subscription to *AKC Family Dog* magazine
- AKC Canine Partners Official Decree
- Complimentary Office Visit with Veterinarian in the AKC Veterinary Network

* Insurance is underwritten and issued by Independence American Insurance Company, rated A- (Excellent) by AM Best Company, with offices at 485 Madison Ave, NY, NY 10022 and in WA, by American Pet Insurance Company, 6100 4th Ave. S., Seattle, WA 98108. Insurance plans are offered and administered by PetPartners, Inc., a licensed agency. "American Kennel Club," "AKC" and the AKC logo are trademarks of The American Kennel Club, Inc.; used under license by PetPartners. "AKC Pet Insurance" is the name used by PetPartners to offer and administer insurance plans and is neither an American Kennel Club business nor an insurance company. American Kennel Club does not offer, administer, solicit, market or sell any insurance plans. For complete details refer to www.akcpetinsurance.com/sample-policies. The 30-day coverage must be activated in most states. Eligibility restrictions apply. For more information, visit www.akcpetinsurance.com/certificate or call 866-725-2747.

